

Washer Types

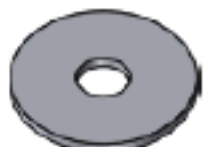

Flat

A flat washer, used to distribute load. Available in SAE, USS and other patterns.



Fender

An oversize flat washer used to further distribute load especially on soft materials.



Finishing

A washer used to obtain a 'finished' look. Usually used with oval head screws.



Split Lock

The most common style of washer used to prevent nuts and bolts from backing out.



External Tooth Lock

A washer with external 'teeth'. Used to prevent nuts and bolts from backing out.



Internal Tooth Lock

A washer with internal 'teeth'. Used to prevent nuts and bolts from backing out.

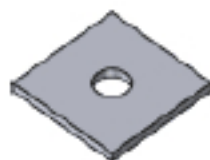

Square

A square shaped washer.

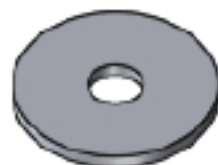

Dock

Dock washers have a larger outside diameter and are thicker than standard.



Ogee

Thick, large diameter, cast iron washers with a curved or sculpted appearance. Typically used in dock and wood construction.



Sealing

A soft neoprene washer bonded to a metal backing. Used to seal out air/water or dampen noise and vibration.